



*Columbus*  
*C-SERIES*

# *Columbus*

---

## *C-SERIES*

## **TRAVEL WHERE THE ROAD TAKES YOU**

Explore new places and create long-lasting memories in an RV that feels like home. Designed to reflect the insights of a seasoned 5th wheel enthusiast, the Columbus C-Series is distinctively styled with residential details. 101"-wide body, residential appliances, drop-frame chassis and a tire monitoring system are just a few of the luxury features that help make the C-Series perfect for helping live out "the good old days".





## **Construction**

101"-Wide Body  
 All Welded Aluminum Frame Superstructure  
 Climate Controlled Drop-Frame Storage  
 5/8" Tongue & Groove Plywood Floor  
 Residential, 5", Radius, Wood-Truss Roof  
 6'11" Height Living Area Slides (N/A 388FKC)  
 Heat Ducts In Out-Of-Traffic Areas  
 Snap-In Ceiling Molding (No Staples Or Tape)  
 12V Heat Pads On All Holding Tanks  
 R-38 Floor Insulation  
 R-40 Roof Insulation  
 R-11 Sidewall Insulation  
 MORyde CRE3000 Suspension System  
 Vacuum-Bonded Walls  
 Lippert Axles  
 16" Wheels With Nitrogen-Filled Tires  
 Rear-View Camera Prep  
 Slide Topper Prep  
 Painted Fiberglass Front Cap

## **Interior**

Large, Tinted Windows Throughout  
 Hidden Hinges  
 Soft-Close, Reinforced Doors & Drawers With Upgraded Hardware  
 Upgraded Crack/Mold/Mildew-Resistant Flooring  
 Upgraded True Solid-Surface Countertops In Kitchen  
 LED Light Fixtures  
 Residential Crown Molding Throughout Unit  
 Solid Wood Slide Fascia  
 Roller Night Shades  
 Solid Wood Steps  
 Large Entry Closet For Jacket & Shoe Storage (Some Models)



## **Exterior**

Slam Latches On All Storage Doors  
 Magnetic Compartment Door Holds  
 Two-Tone Aluminum Wheels  
 Grey Wheel Well Skirting  
 Painted Fiberglass Front Cap  
 Heated Utility Convenience Center  
 Black Tank Flush  
 Outside Shower  
 Two 30 Lb. LP Tanks  
 Entry Door With Window & Screen Door  
 Battery Quick-Disconnect  
 Power Awning With LED Lighting  
 7,000 Lb. Axles  
 Crank-Down Spare Tire  
 Storage Rack In Front Compartment  
 Tire Pressure Monitoring System  
 2" Hitch Receiver

## **Kitchen**

Full Pantry (Some Models)  
 Trash Can With Dedicated Storage (Some Models)  
 Rollaway Sink Covers  
 Residential Under Counter Storage  
 Residential Backsplash  
 Additional Flush Lighting Above Sink Area  
 Deep-Bowl Stainless Steel Sink  
 Single-Lever Faucet With Pull-Out Sprayer

## **Bedroom**

15,000 BTU Coleman Serenity Bedroom A/C  
 TV Backer & Hookups For 32"  
 Pressed-Top Dresser Top  
 King Size, Pillow-Top Mattress  
 Mirrored, Sliding Closet Doors  
 High-End Bedspread & Pillows  
 Reading Lights With USB Charging Ports

## **Bathroom**

Large Shower Surround With Seat And Built-In Shelves  
 Pressed-Top Counter Top  
 Three-Speed Power Vent  
 Porcelain Toilet  
 Shower Skylight

## **Furniture**

Power Theater Seating With USB Charging  
 50/50 Split Sleeper Sofa (Per Model)  
 Solid Wood Entertainment & Table Top  
 Residential High-End Dining Chairs

## **Appliances**

Insignia 4-Burner Gas Cooktop  
 Insignia 24" Residential Oven  
 50" TV With External Speakers  
 10 Gallon Water Heater With Quick Recovery  
 Washer/Dryer Prep  
 Full-System Water Purifier  
 20 Cu. Ft. Residential Refrigerator With 1,000W Inverter  
 30" Residential Microwave  
 15,000 BTU High-Output Coleman Serenity A/C  
 35,000 BTU Furnace  
 Omnidirectional Roof Antenna With 4G LTE/WiFi Prep  
 50 Amp Converter With Built-In Charge Wizard

## **Options**

Stackable Washer/Dryer  
 Dual-Pane Windows  
 18 Cu. Ft. Gas/Electric Refrigerator  
 Generator Prep  
 200W Solar Panels With Batteries  
 17.5" Goodyear H-Rated Tires With Upgraded Rims  
 Slide Toppers  
 London Ash Cabinetry W/Midnight Decor or  
 Americano Cabinetry W/Pebble Decor

## COMPASS PACKAGE

- Six-Point Hydraulic Leveling System
- Tire Pressure Monitoring System
- Two 15,000 BTU Coleman Serenity A/C Units
- 2" Hitch Receiver
- 20 Cu. Ft. Residential Refrigerator
- 50" Entertainment TV With External Speakers
- Two-Tone Aluminum Wheels
- G-Rated Tires
- 12V Heat Pads On All Holding Tanks
- Kitchen Maxx Air Vent With Rain Hood
- Electric Fireplace
- Metal-Wrapped Awning
- Two Residential Dinette Chairs
- Quick Battery Disconnect
- LED Awning Lights
- Syphon 360 Vent Covers
- MCD Night Shades
- MORryde Strut Assist Step Above Entry Step
- Friction-Hinge Entry Door With Glass Window
- Go Power Solar Prep
- Pull-Down Faucet
- Ladder
- King Bed
- Hybrid Carpet
- Two Folding Chairs
- Aluminum Bed Base



London Ash Cabinetry



For more photos and information visit [www.palominorv.com/c-series](http://www.palominorv.com/c-series)

# Columbus

## C-SERIES

### Floorplans

299RLC



HITCH WEIGHT	UVW	GVWR	CCC	OVERALL LENGTH	EXT. HEIGHT (w/AC)	EXT. WIDTH	FRESH WATER	GREY WATER	BLACK WATER	AWNING SIZE
2180 Lb.	11284 Lb.	15880 Lb.	4596	36' 1"	13' 6"	101"	75 Gal.	78 Gal.	39 Gal.	16' & 11"

329DVC



HITCH WEIGHT	UVW	GVWR	CCC	OVERALL LENGTH	EXT. HEIGHT (w/AC)	EXT. WIDTH	FRESH WATER	GREY WATER	BLACK WATER	AWNING SIZE
2035 Lb.	11964 Lb.	14962 Lb.	2998	37' 6"	13' 6"	101"	75 Gal.	71 Gal.	39 Gal.	17' & 11"



Americano Cabinetry

383FBC

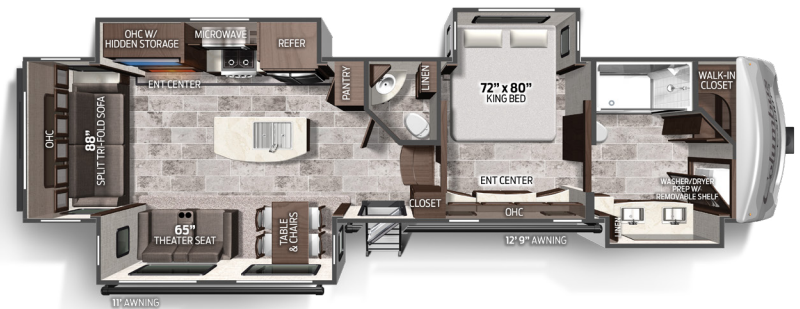

HITCH WEIGHT	UVW	GVWR	CCC	OVERALL LENGTH	EXT. HEIGHT (w/AC)	EXT. WIDTH	FRESH WATER	GREY WATER	BLACK WATER	AWNING SIZE
2573 Lb.	13322 Lb.	16150 Lb.	2828	41' 2"	13' 6"	101"	75 Gal.	78 Gal.	78 Gal.	13' & 11"

379MBC



HITCH WEIGHT	UVW	GVWR	CCC	OVERALL LENGTH	EXT. HEIGHT (w/AC)	EXT. WIDTH	FRESH WATER	GREY WATER	BLACK WATER	AWNING SIZE
2100 Lb.	12624 Lb.	15580 Lb.	2956	41' 2"	13' 6"	101"	75 Gal.	71 Gal.	39 Gal.	20' & 11"

382FBC

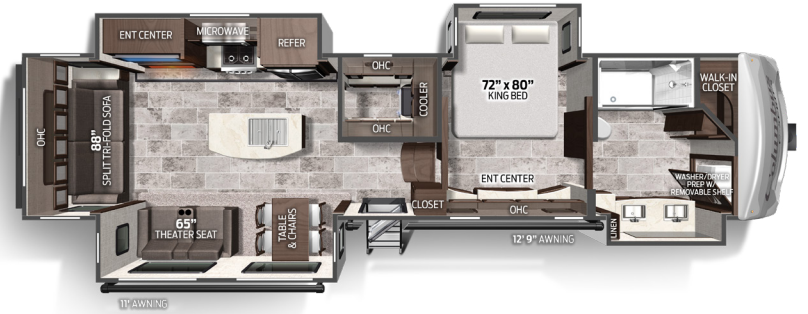

HITCH WEIGHT	UVW	GVWR	CCC	OVERALL LENGTH	EXT. HEIGHT (w/AC)	EXT. WIDTH	FRESH WATER	GREY WATER	BLACK WATER	AWNING SIZE
2573 Lb.	13122 Lb.	16150 Lb.	3028	41' 2"	13' 6"	101"	75 Gal.	78 Gal.	39 Gal.	12' 9" & 11"

384RKC

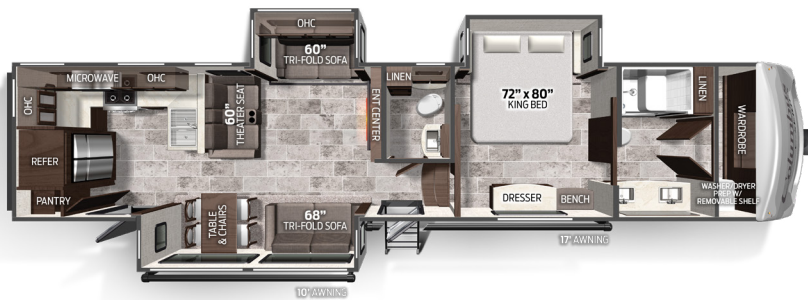

HITCH WEIGHT	UVW	GVWR	CCC	OVERALL LENGTH	EXT. HEIGHT (w/AC)	EXT. WIDTH	FRESH WATER	GREY WATER	BLACK WATER	AWNING SIZE
2600 Lb.	12819 Lb.	16600 Lb.	3781	42' 2"	13' 6"	101"	75 Gal.	78 Gal.	78 Gal.	18' & 11"

388FKC



HITCH WEIGHT	UVW	GVWR	CCC	OVERALL LENGTH	EXT. HEIGHT (w/AC)	EXT. WIDTH	FRESH WATER	GREY WATER	BLACK WATER	AWNING SIZE
2367 Lb.	13744 Lb.	16743 Lb.	2999	41' 2"	13' 6"	101"	75 Gal.	75 Gal.	39 Gal.	18' 6"

# PALOMINO

COLUMBUS BY PALOMINO  
A Division Of Forest River, Inc.  
105-1/2 C.R. 14 • Middlebury, In 46540  
[www.palominorv.com](http://www.palominorv.com)

**GVWR (Gross Vehicle Weight Rating)** - is the maximum permissible weight of the unit when fully loaded. It includes all weights, inclusive of all fluids, cargo, optional equipment and accessories. For safety and product performance do NOT exceed the GVWR.

**GAWR (Gross Axle Weight Rating)** - is the maximum permissible weight, including cargo, fluids, optional equipment and accessories that can be safely supported by a combination of all axles.

**UVW (Unloaded Vehicle Weight)\*** - is the typical weight of the unit as manufactured at the factory. It includes all weight at the unit's axle(s) and tongue or pin and LP Gas. The UVW does not include cargo, fresh potable water, additional optional equipment or dealer installed accessories.

**CCC (Cargo Carrying Capacity)\*\*** - is the amount of weight available for fresh potable water, cargo, additional optional equipment and accessories. CCC is equal to GVWR minus UVW. Available CCC should accommodate fresh potable water (8.3 lbs per gallon). Before filling the fresh water tank, empty the black and gray tanks to provide for more cargo capacity.

\*Estimated Average based on standard build optional equipment. \*\* Estimated average based on standard build optional equipment

Each Forest River RV is weighed at the manufacturing facility prior to shipping. A label identifying the unloaded vehicle weight of the actual unit and the cargo carrying capacity is applied to every Forest River RV prior to leaving our facilities.

The load capacity of your unit is designated by weight, not by volume, so you cannot necessarily use all available space when loading your unit.

All information contained in this brochure is believed to be accurate at the time of publication. However, during the model year, it may be necessary to make revisions and Forest River, Inc., reserves the right to make all such changes without notice, including prices, colors, materials, equipment and specifications as well as the addition of new models and the discontinuance of models shown in this brochure. Therefore, please consult with your Forest River, Inc., dealer and confirm the existence of any materials, design or specifications that are material to your purchase decision. ©2021 Palomino RV, a Division of Forest River, Inc., a Berkshire Hathaway Company. 10/19 Columbus

## 24/7 EMERGENCY ROADSIDE ASSISTANCE WITH VEHICLE PURCHASE\*

TOWING  
JUMP-STARTS  
TIRE CHANGES  
FLUID DELIVERY  
LOCKOUT  
SERVICE

WINCH-OUT  
MOBILE MECHANIC  
TECHNICAL  
SUPPORT  
DEALER LOCATOR  
SERVICES



\*VALID FOR 1 YEAR FROM DATE OF PURCHASE



### PRE-DELIVERY INSPECTION FACILITY

20,000 square feet of quality assurance. The bare essentials for a premium product. This state-of-the-art facility gives immediate daily feedback to production for quality assurance in every unit built.

## CUSTOMER SATISFACTION



[www.ForestRiverBuyLocal.com](http://www.ForestRiverBuyLocal.com)



**Learn More**  
Scan this barcode using a QR Reader on your smart phone to learn more about Forest River.



A Berkshire Hathaway company.

**FREE MEMBERSHIP**  
to Forest River Owners' Group

[www.forestriverfrog.com](http://www.forestriverfrog.com)



### FOREST RIVER RV OWNER'S GUIDE APP

Now you can have your Owner's Manual with you wherever you are. Download our FREE App from the App Store or Google Play and you'll have the information right at your fingertips.

